

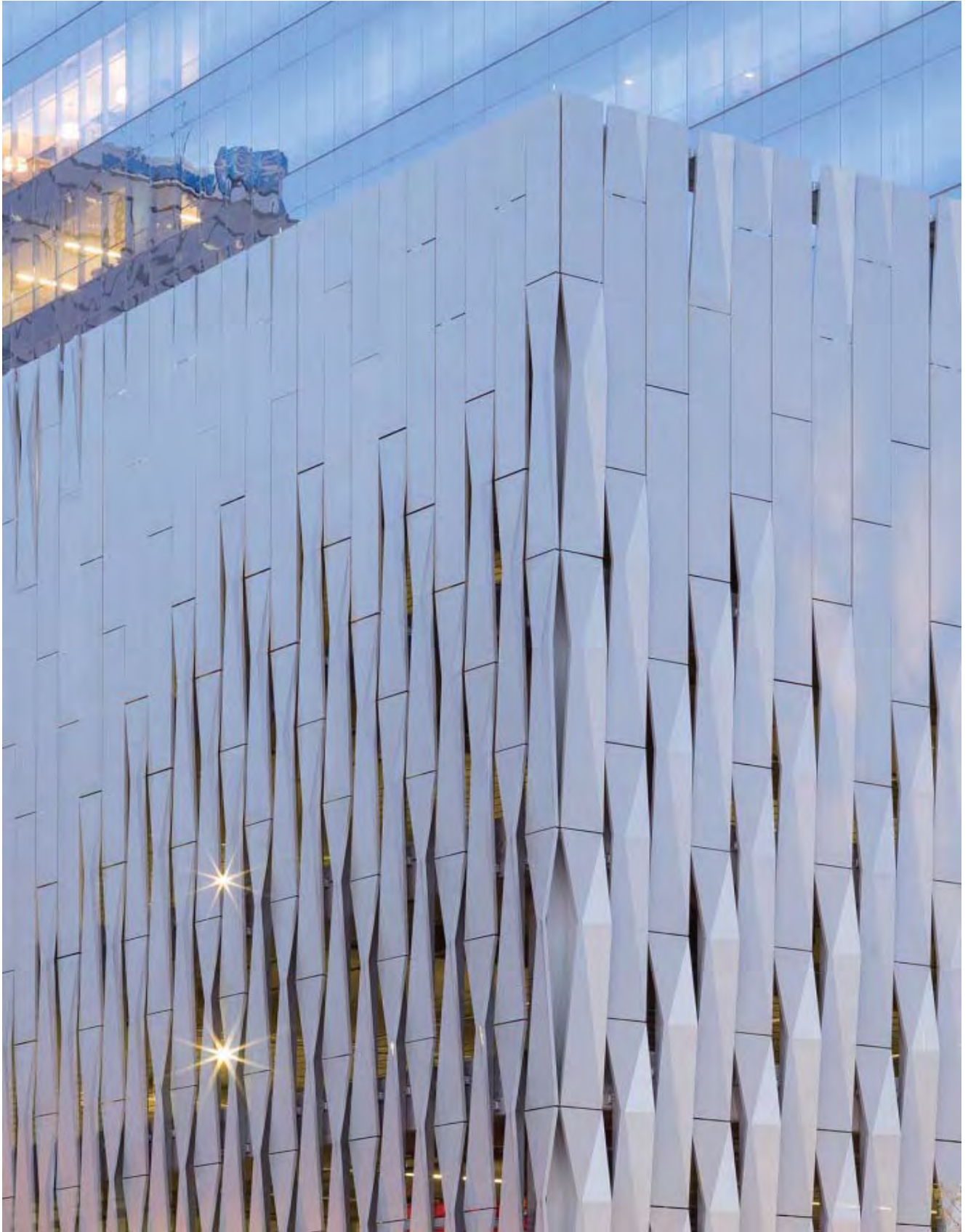

Metal Wall Ceiling







PRODUCT DESCRIPTION

TOPTIDE/Ceillex metal wall claddings are made from aluminum solid panel, aluminum honeycomb panel and metal/aluminum mesh panel as decorative surface layer, which are connected to the main body of buildings by supporting structures behind. They also include structures required for fireproof, lightning protection, thermal insulation, acoustic insulation, ventilation, sunshade or other functions. Metal wall claddings have characteristic textures in different & durable colors, diversified appearances and shapes. They can be perfectly mixed with glass or stone curtain wall.

Features:

1. Light weight, high strength, anti-corrosion, PVDF finish with 25-year warranty.
2. Nice workability, can be processed into plain, arc, spherical and other complex geometric shapes.
3. Easy to clean and maintain, low maintenance cost, recyclable.
4. Customization production at factory, convenient installation at the site.



China A1



NRC up to 0.95





TYPICAL DESIGNS



Outline

Aluminum Solid Panel /
Aluminum Honeycomb
Panel

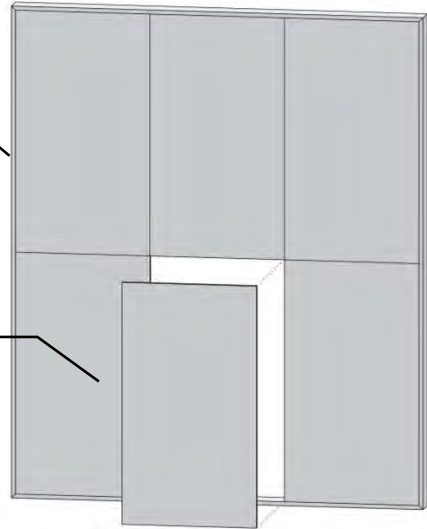

Outline

Aluminum Solid Panel /
Aluminum Honeycomb
Panel

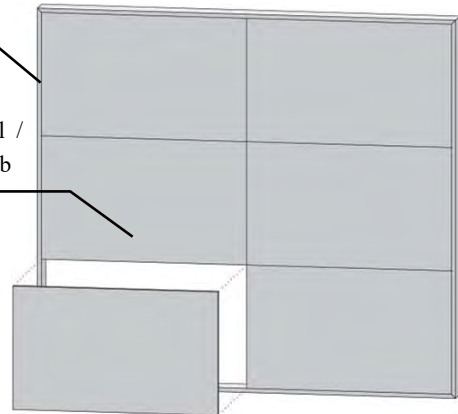

Outline

Wavy Aluminum Solid
Panel

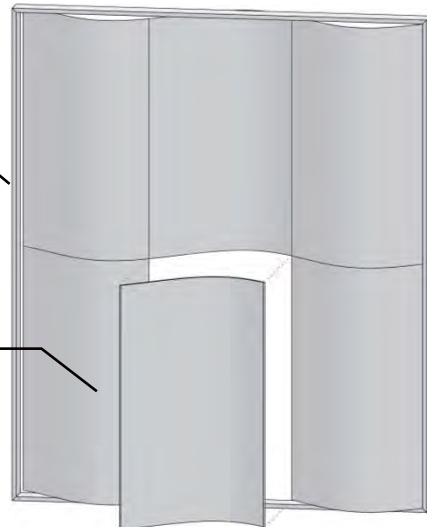

TYPICAL DESIGNS

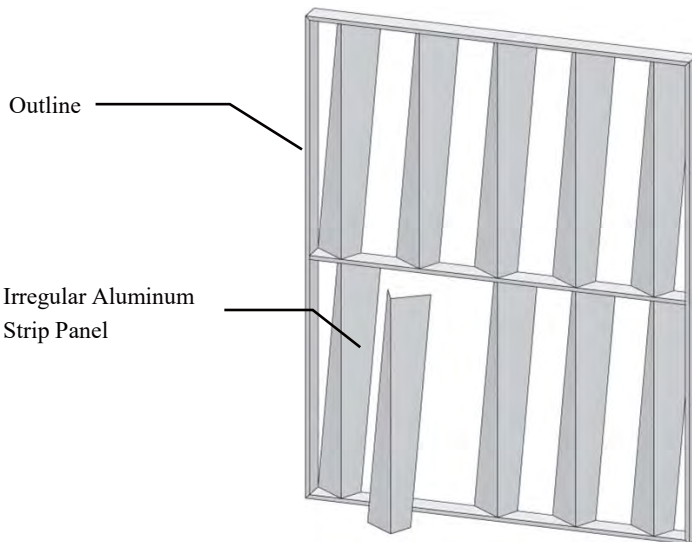
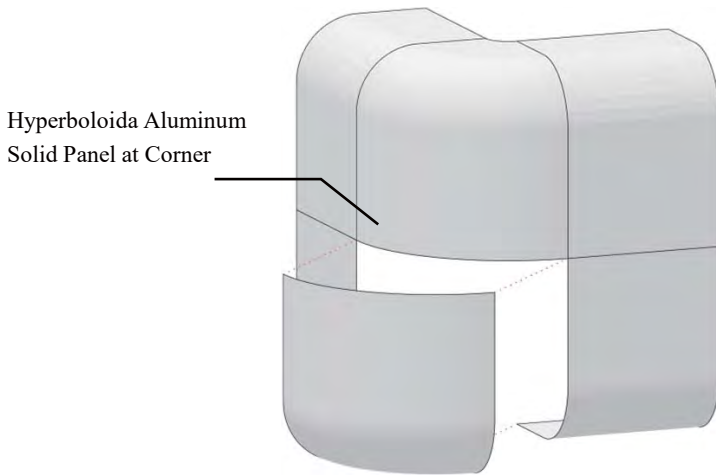
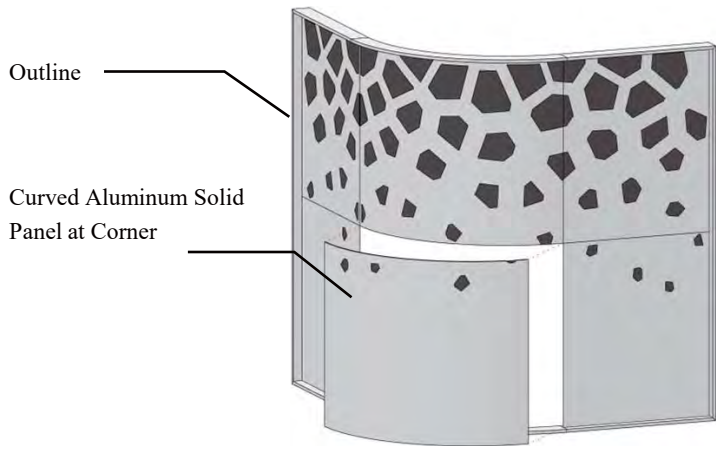

TYPICAL DESIGNS

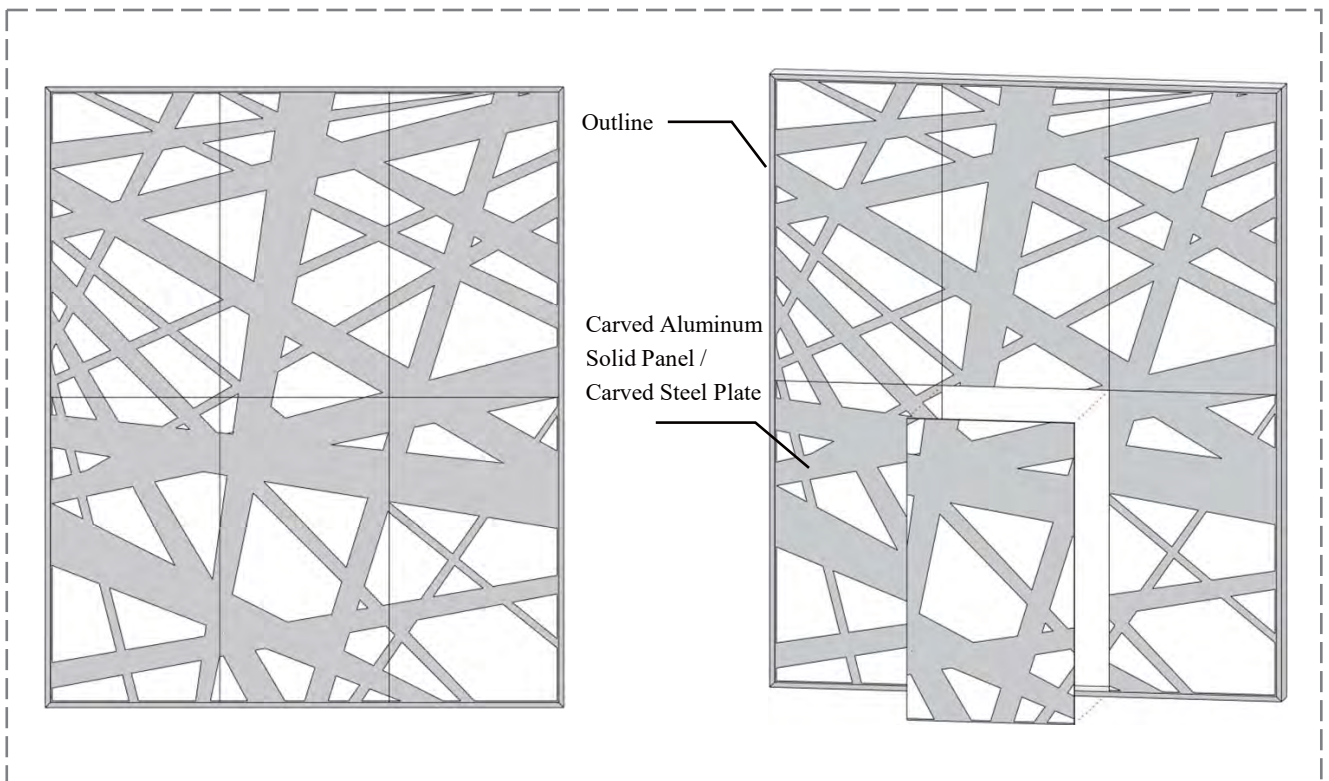

TYPICAL DESIGNS

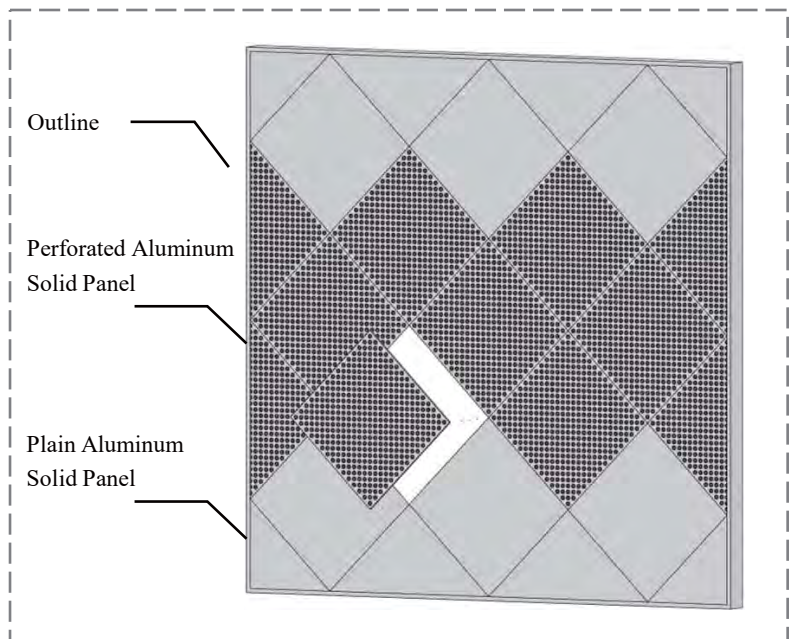
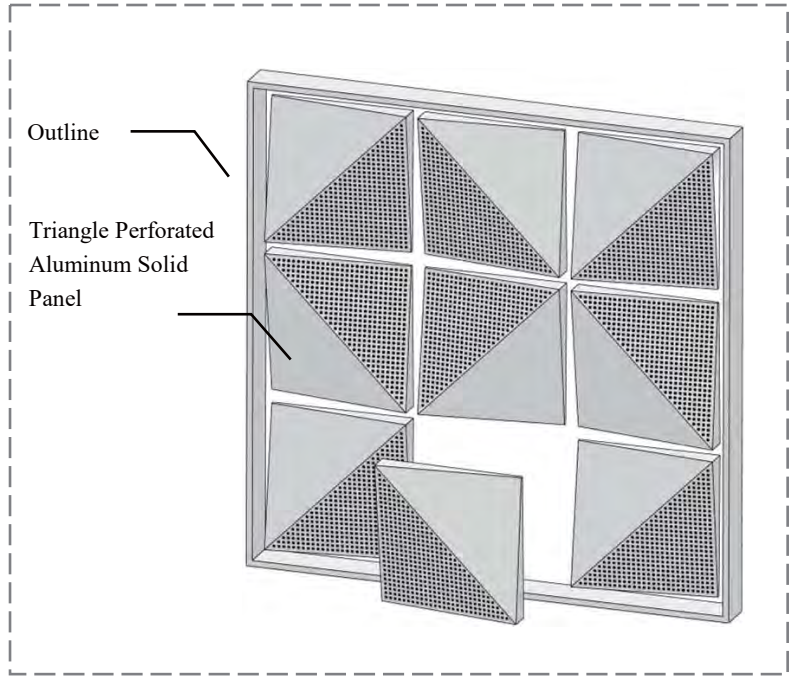

TYPICAL DESIGNS

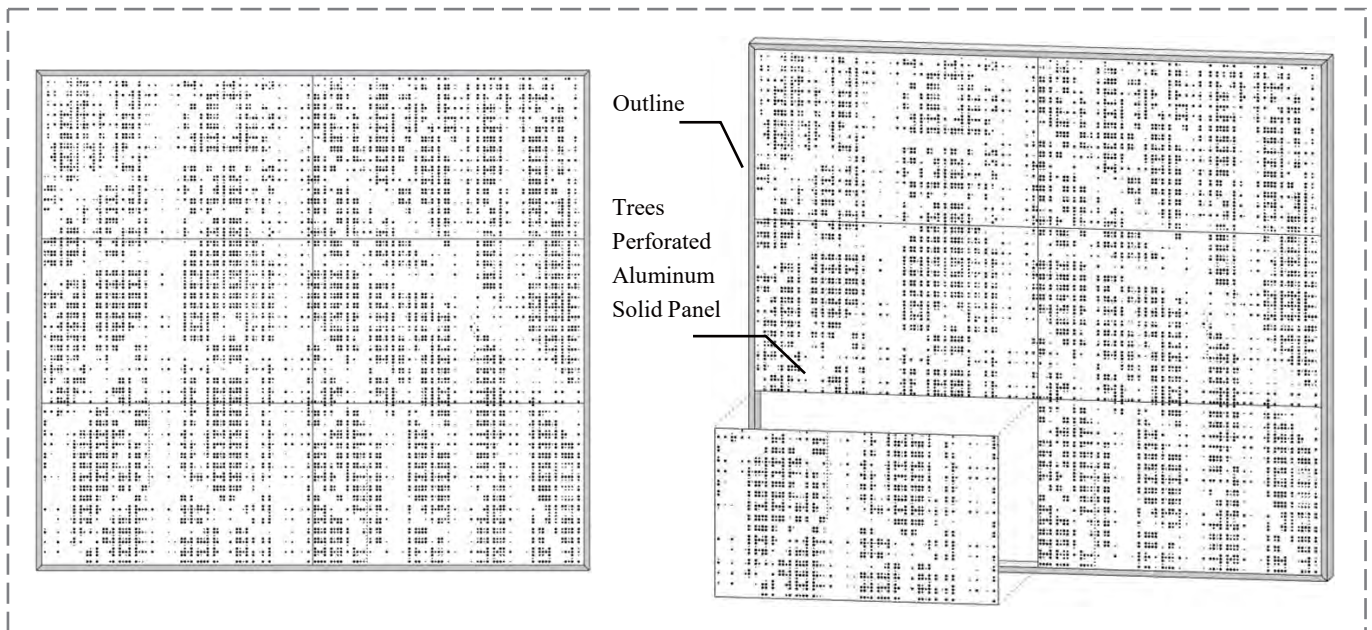

TYPICAL DESIGNS

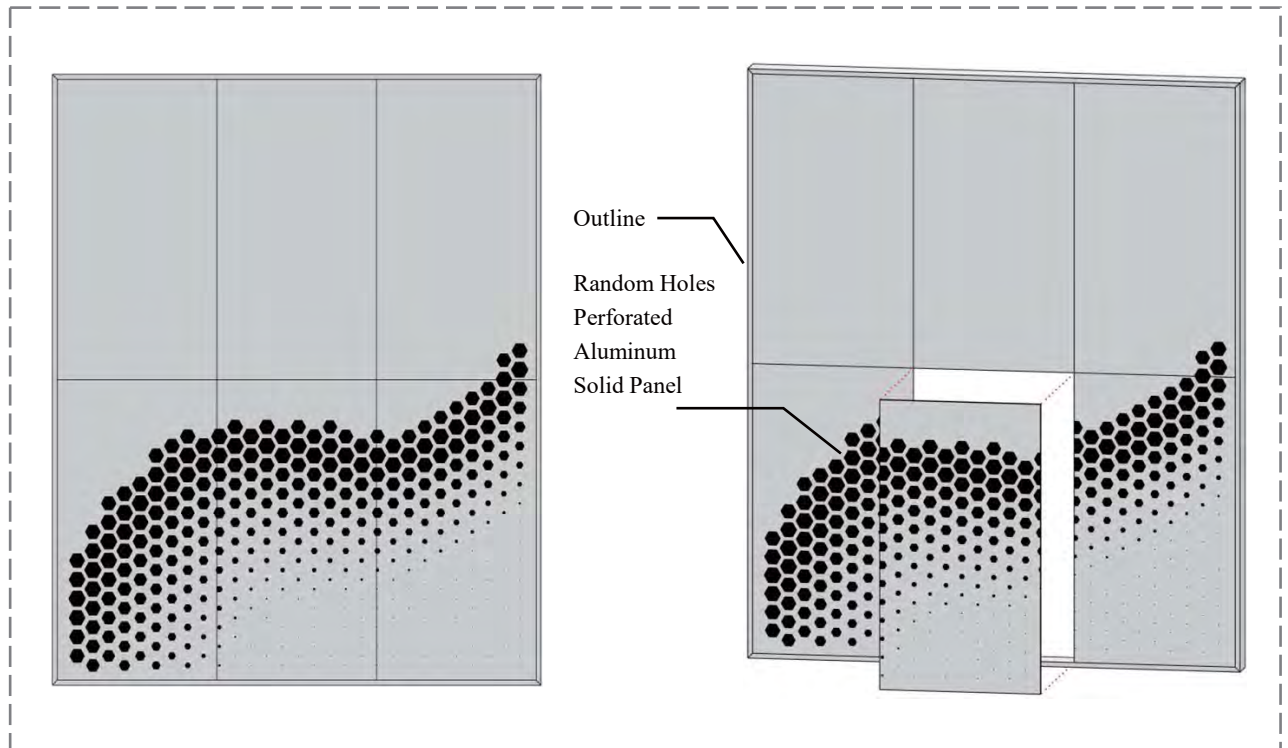

INSTALLATION STRUCTURES

Type 01 - Fixed With Brackets (Seamless Joint)

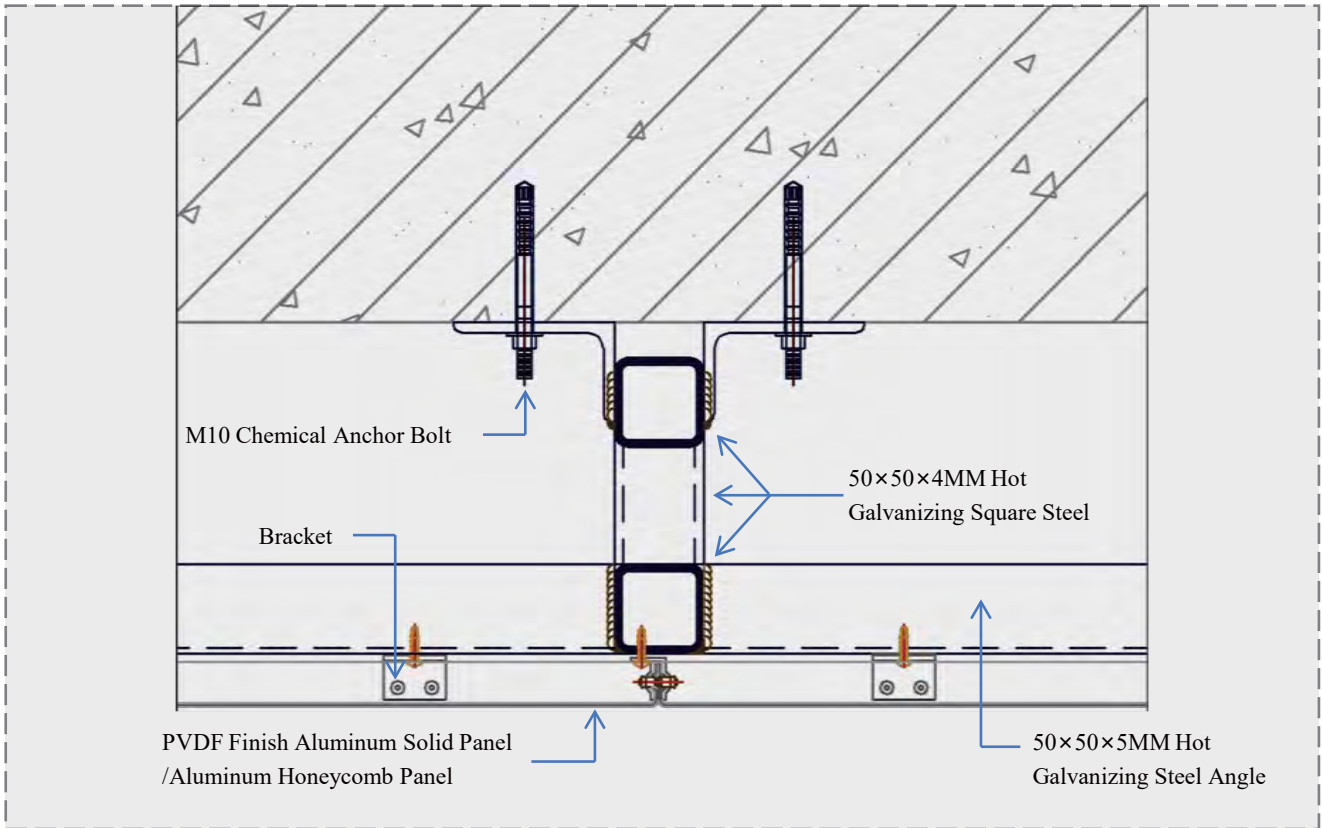

Type 02 - Fixed With Brackets (Gap Filled With Silicone)

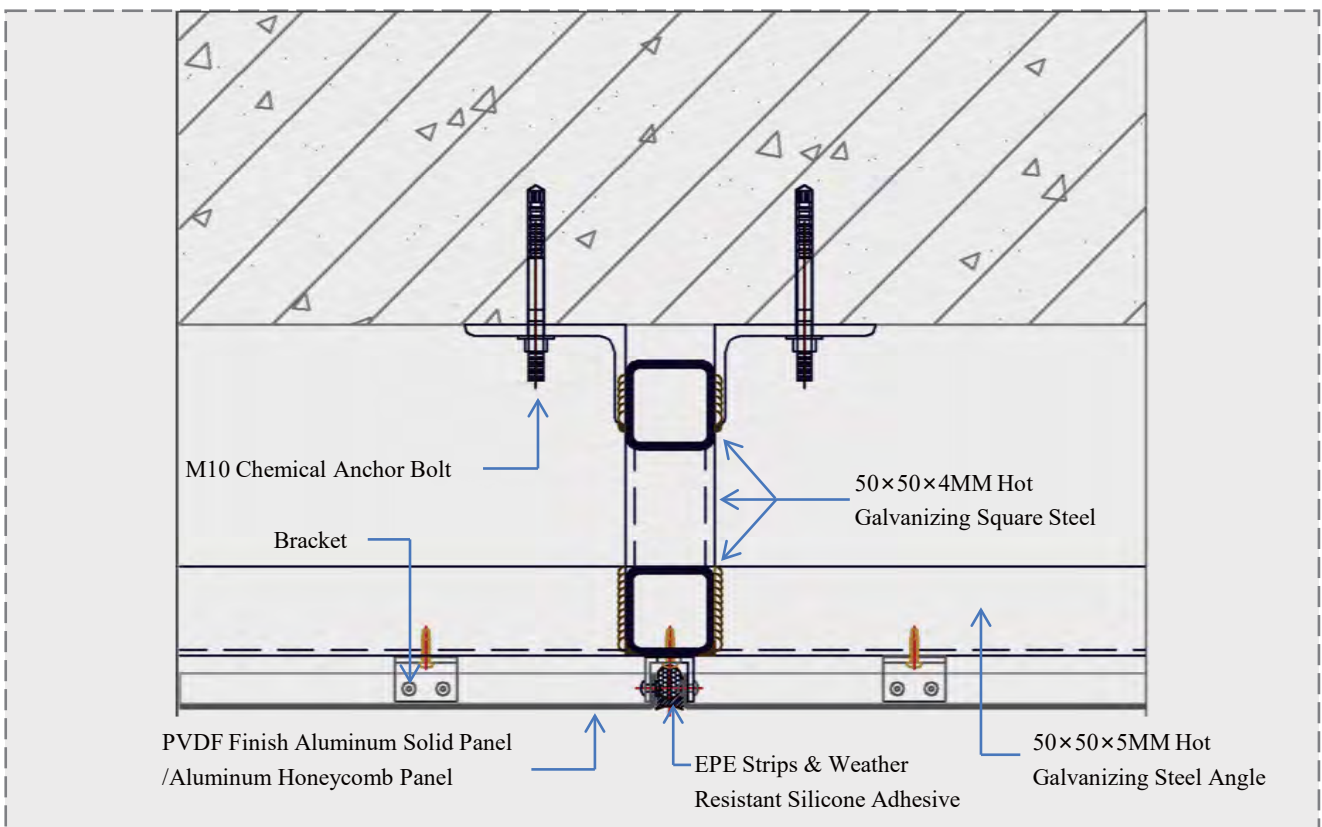

INSTALLATION STRUCTURES

Type 03 - Dry Hanging System (Seamless Joint)

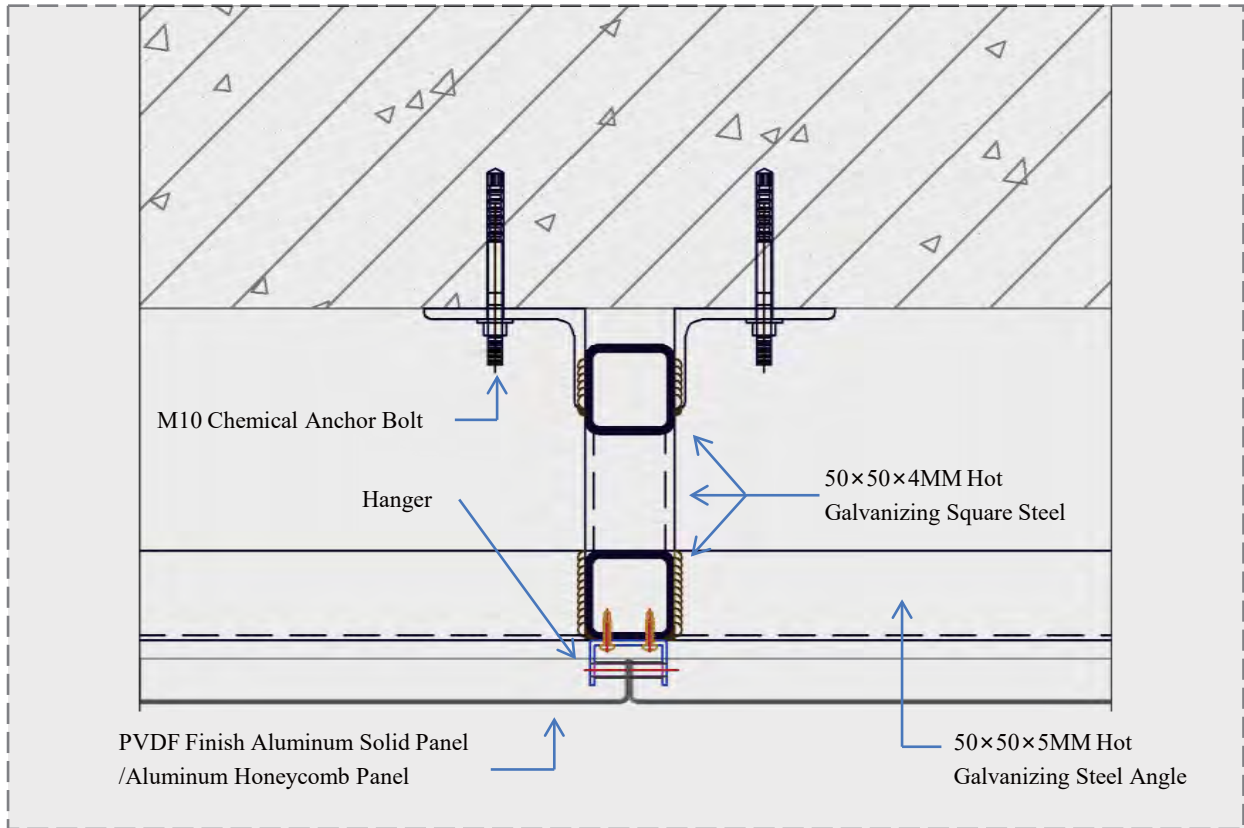

Type 04 - Dry Hanging System (Gap Filled With Silicone)

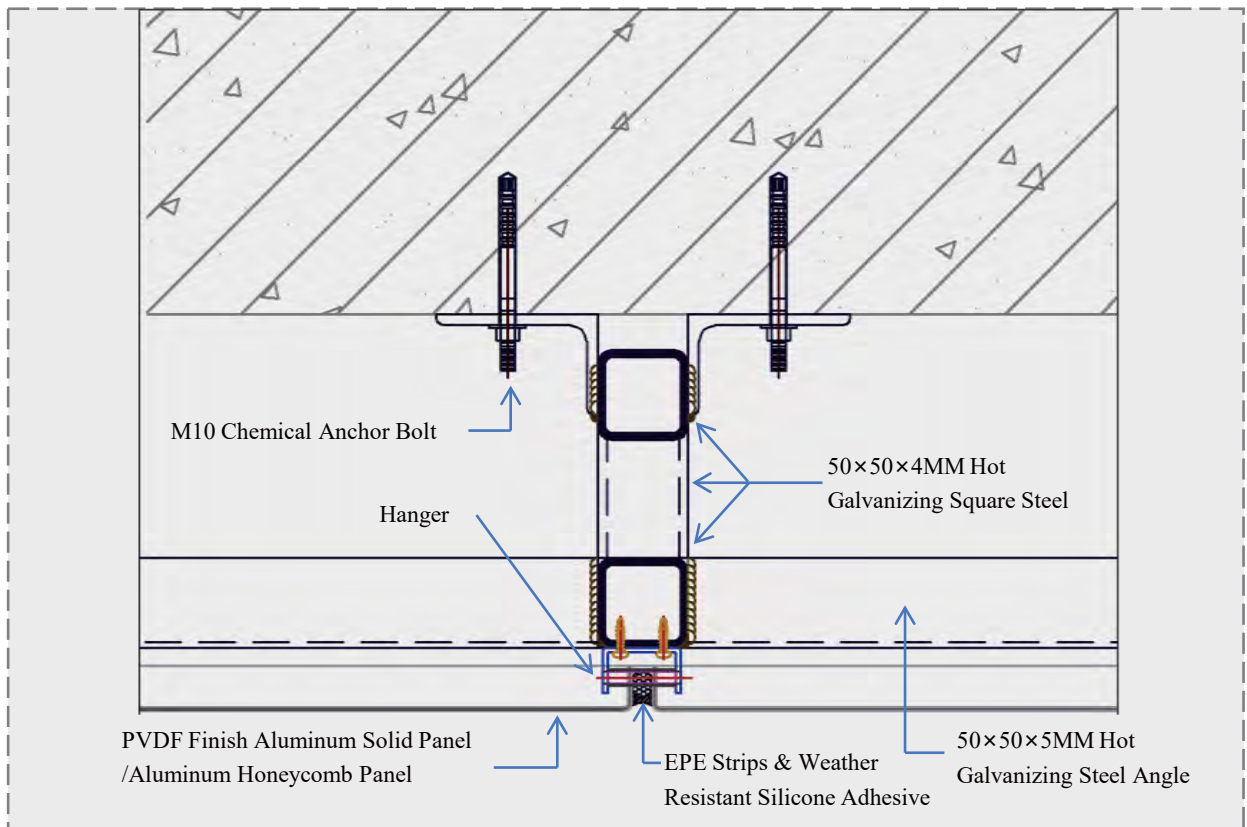

PRODUCT SPECIFICATIONS

Materials

Aluminum Solid Panel (2.0/2.5/3.0/4.0mm)
 Aluminum Honeycomb Panel (12/15/20/25/30mm)
 Aluminum Mesh Panel (2.0/2.5/3.0/4.0mm)

Aluminum Profile (1.5 ~ 3.0mm)
 Steel Plate (1.2/1.5mm)
 Steel Mesh Panel (1.2/1.5/2.0mm)

Typical Sizes

1000×1000mm, 1000×2000mm, 1220×2440mm
 1250×3200mm, 1350×4000mm, 1500×4200mm

Optional Sizes

Width ≤ 1500mm, Length ≤ 6000mm
 Customized sizes in above range are available.

PRODUCT LAYOUT

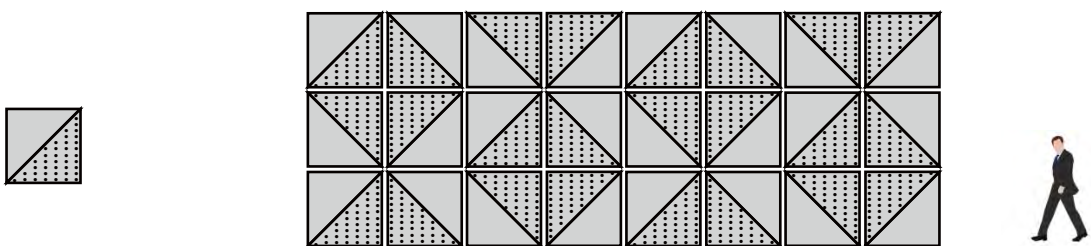
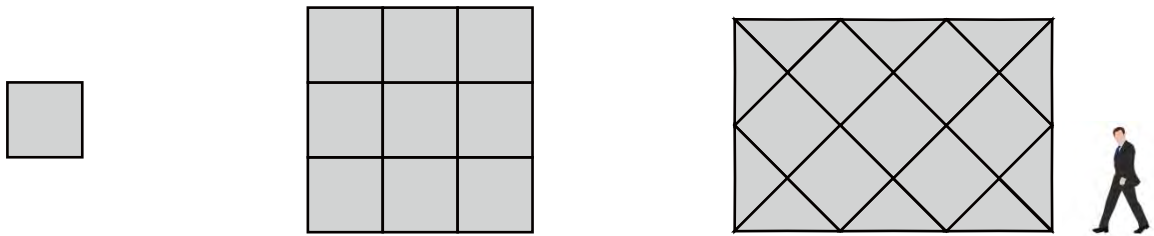
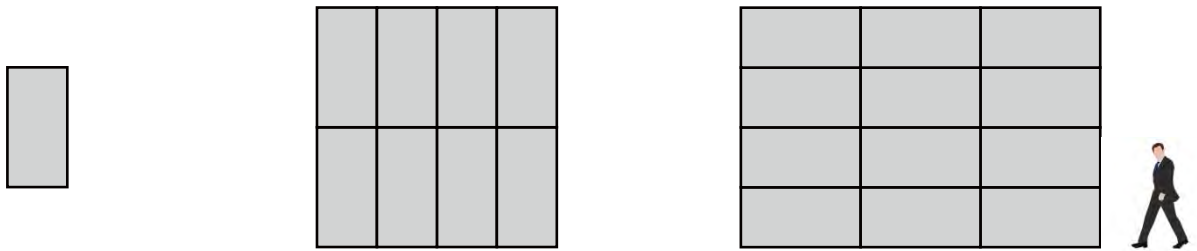



PRODUCT LAYOUT

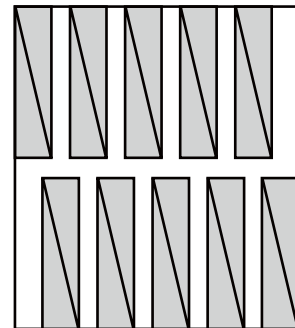
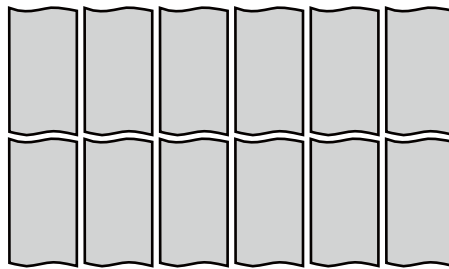
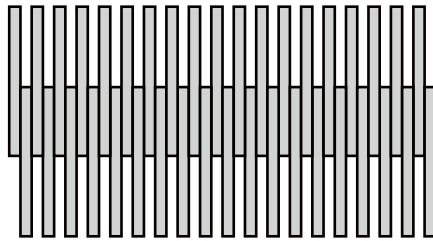
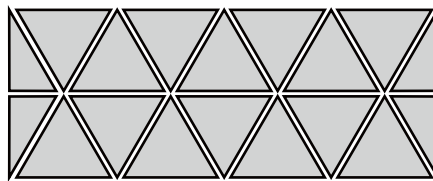
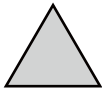
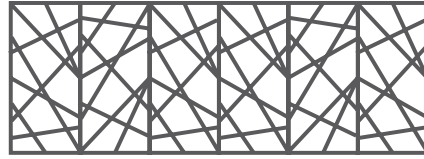

PERFORATIONS

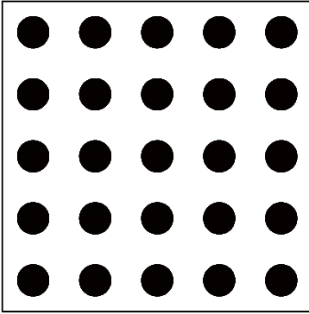

Type: Round Straight
Hole size: 15mm
C/C: 30 × 30mm

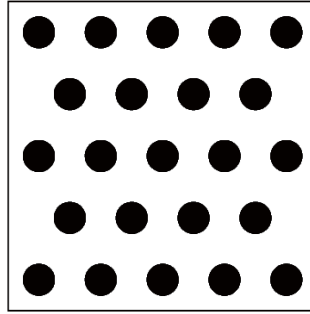

Type: Round Diagonal
Hole size: 15mm
C/C: 30 × 30mm

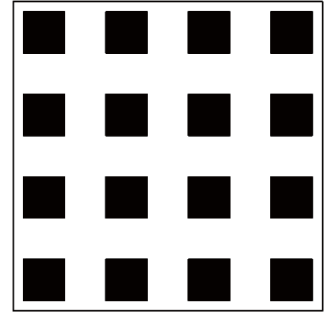

Type: Square Straight
Hole size: 20mm
C/C: 40 × 40mm

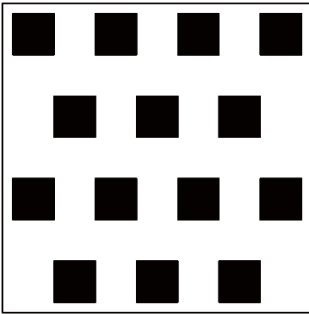

Type: Square Diagonal
Hole size: 20mm
C/C: 40 × 40mm

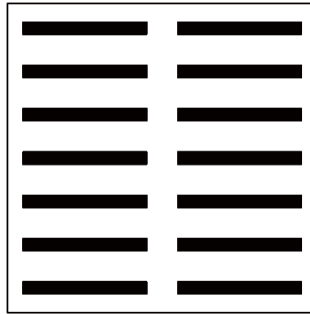

Type: Slotted Straight
Hole size: 6 × 60mm
C/C: 21 × 75mm

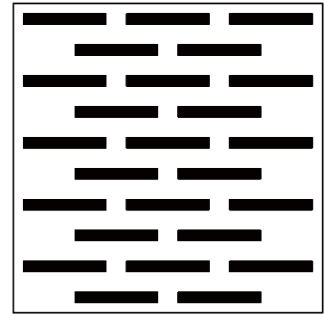

Type: Slotted Diagonal
Hole size: 5 × 40mm
C/C: 15 × 50mm

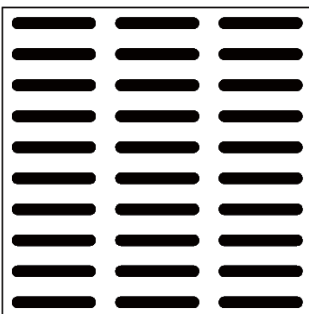

Type: Straight & Oval Slotted
Hole size: 5 × 40mm
C/C: 15 × 50mm

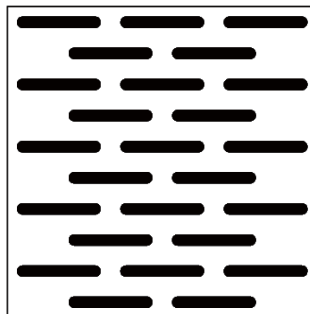

Type: Diagonal & Oval Slotted Hole
size: 5 × 40mm
C/C: 15 × 50mm

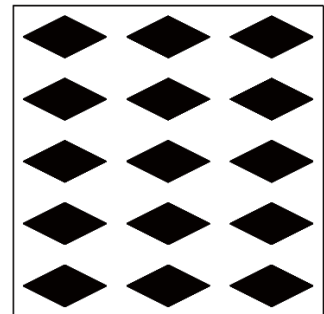

Type: Diamond Straight
Hole size: 20 × 40mm
C/C: 30 × 50mm

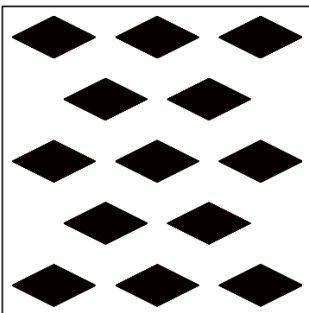

Type: Diamond Diagonal
Hole size: 20 × 40mm
C/C: 30 × 50mm

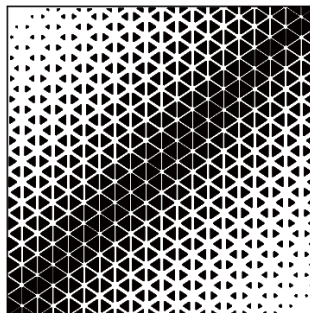

Type: Triangle Gradient

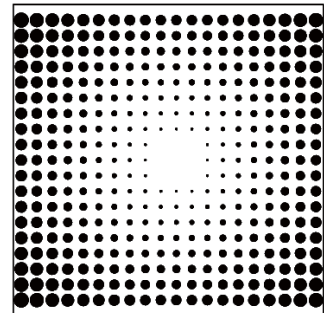

Type: Round Gradient



PERFORATIONS

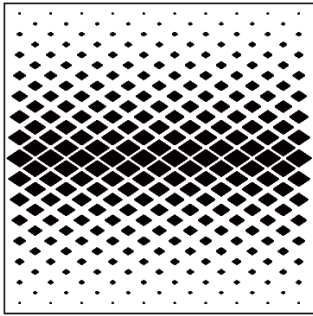

Type: Diamond Gradient 01

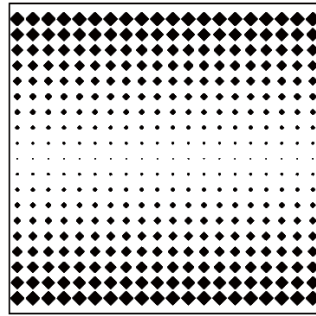

Type: Diamond Gradient 02

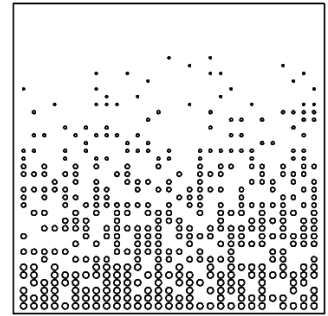

Type: Random Round Holes 01

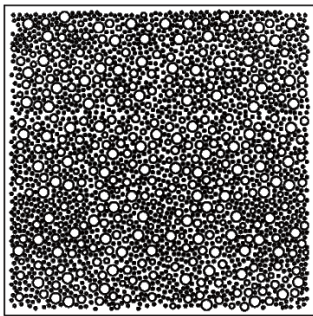

Type: Random Round Holes 02

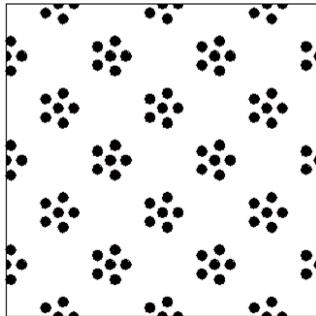

Type: Blossom Round Holes

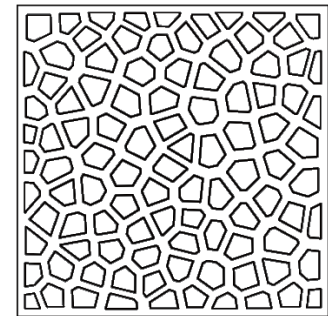

Type: Laser Cutting 01

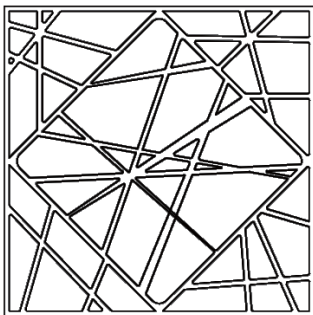

Type: Laser Cutting 02

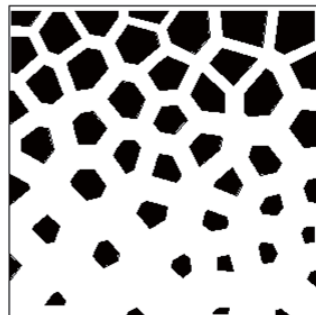

Type: Laser Cutting 03

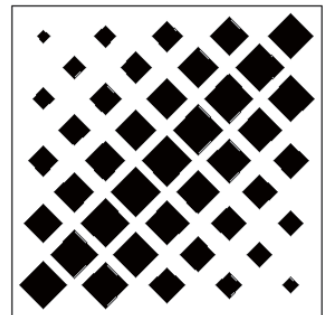

Type: Laser Cutting 04

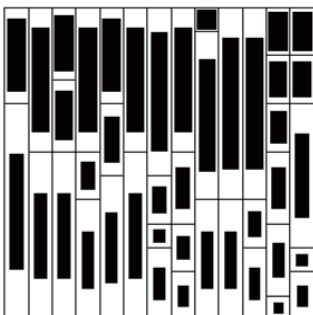

Type: Laser Cutting 05

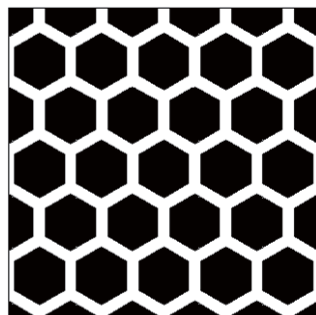

Type: Punching Mesh 01

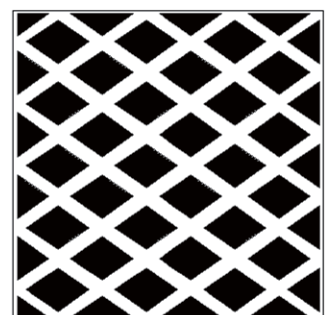

Type: Punching Mesh 02

▲ COLORS

Various colors and shadows as below for choice, and customized colors are available too.
 (Due to printing limitation, color may vary from actual product.)

STANDARD COLORS

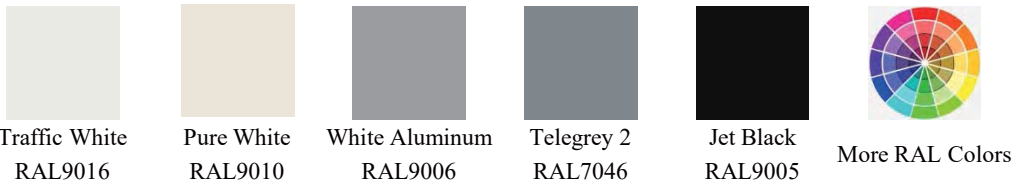

SPECIAL COLORS



PPG PVDF COLORS

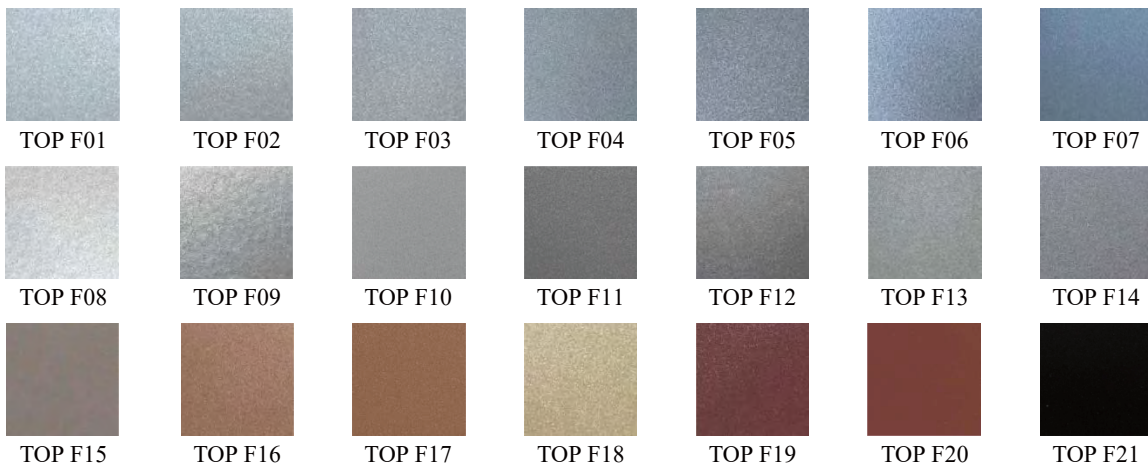

SPECTRA COLORS

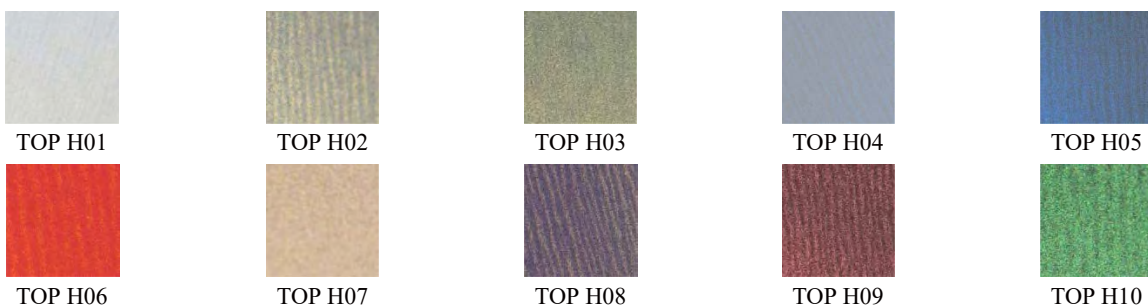

▲ ACCESSORIES

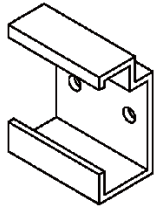

Hanger 01
Material: Galvanized Steel

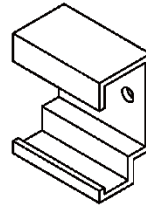

Hanger 02
Material: Galvanized Steel

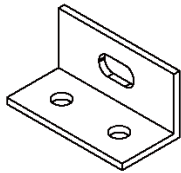

Bracket
Material: Aluminum Alloy

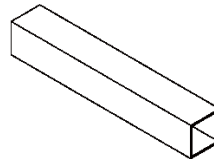

Square Steel
Material: Galvanized Steel

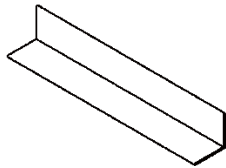

Steel Angle
Material: Galvanized Steel

There are 4 types of installation systems for different structures, which are solid, safe and convenient to install.





▲ CASES



▲ CASES



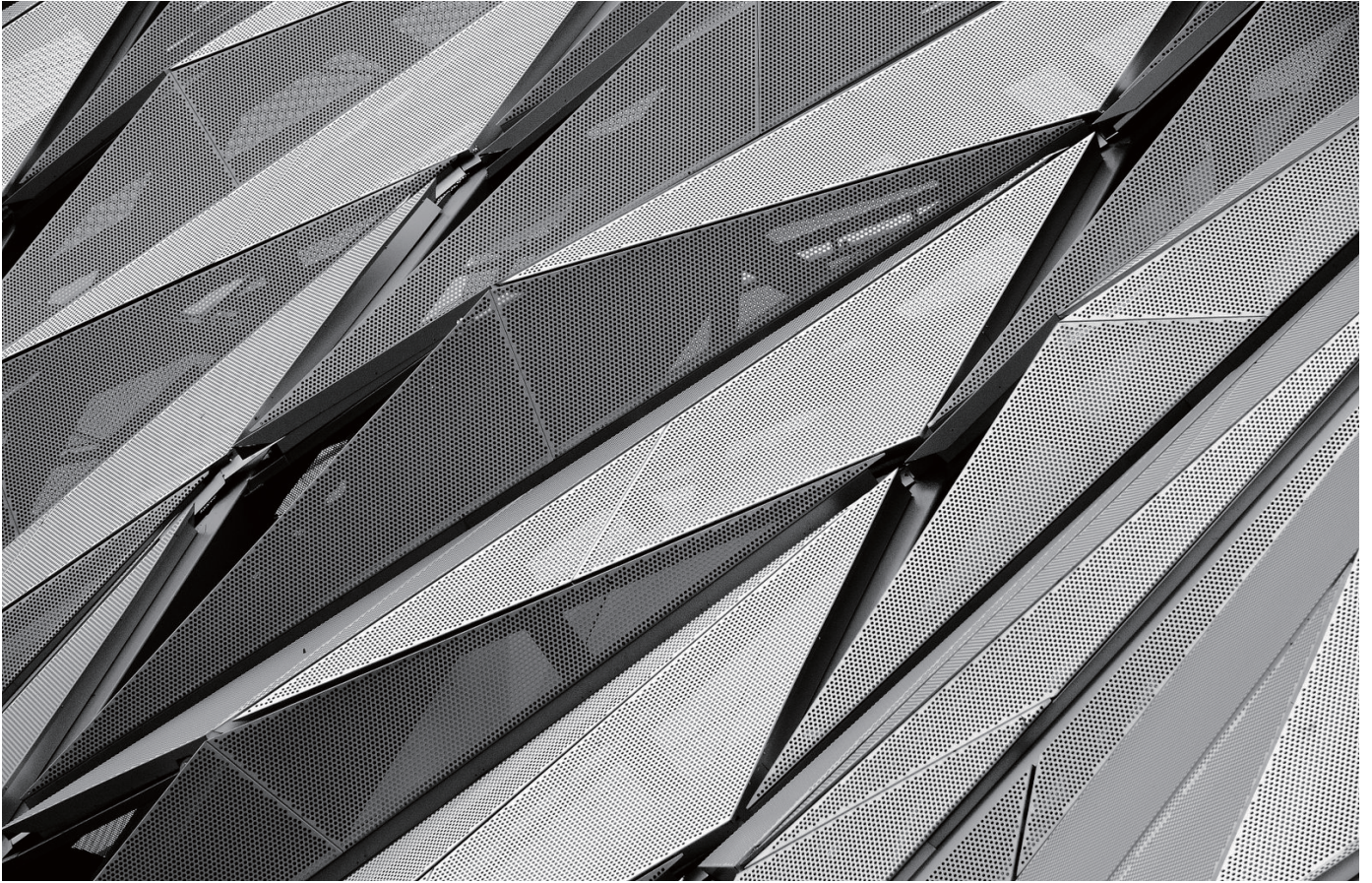

DALIAN INTERNATIONAL CONFERENCE CENTER





株式会社 シーレックス・ジャパン

〒225-0002

神奈川県横浜市青葉区美しが丘 3-55-2

Tel: 045-909-1515 Fax: 045-909-5012

E-mail: mail@ceillex.co.jp URL: www.ceillex.co.jp

